

Parts Breakdown

Model JE-BR-1750-Q 46957

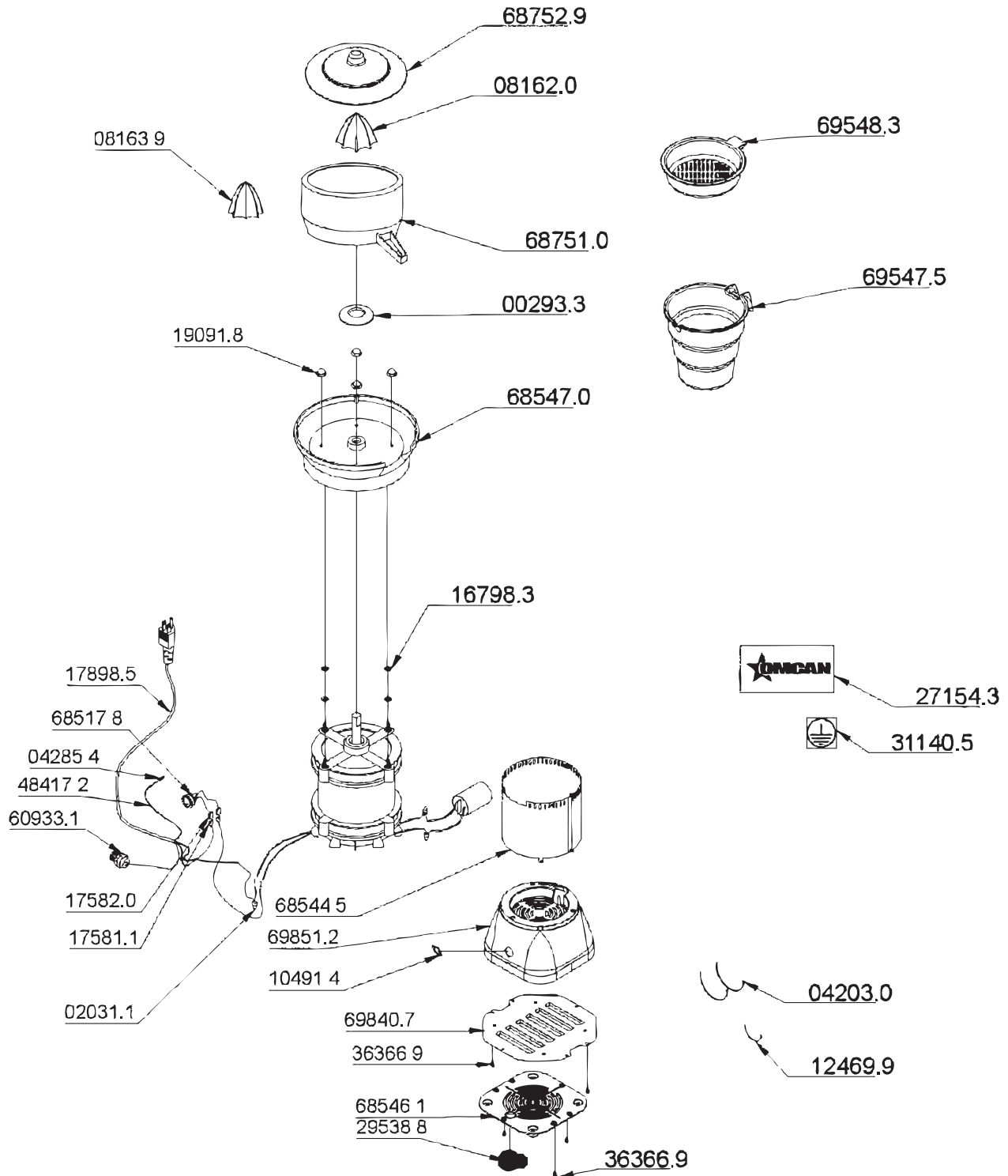

Parts Breakdown

Model JE-BR-1750-Q 46957

| Item No. | Description | Position | Item No. | Description | Position | Item No. | Description | Position |
|----------|------------------------------------|----------|----------|--|----------|----------|---|----------|
| 30031 | Rubber Seal MOL 085375 for 46957 | 00293.3 | 30050 | Terminal Cover for 46957 | 17582.0 | AE758 | Motor 0,25CV 110-127/220-254/220V 50 for 46957 | 65970.3 |
| 30350 | Nylon Cover CN-4472 for 46957 | 02031.1 | 30305 | Cable 3x1.0mm with Plug for 46957 | 17898.5 | AE759 | Key 16123 M5FT4FE3Gy / 220 with 1 RAB for 46957 | 68517.8 |
| 27699 | Clamp T 18R Small for 46957 | 04203.0 | 38148 | Nut M4 DIN 1587 for 46957 | 19091.8 | AE760 | Closure for 46957 | 68546.1 |
| 38089 | Pre Isolating Terminal for 46957 | 04285.4 | 27720 | Omcan Logo (Machines) for 46957 | 27154.3 | AE761 | Black Engine Support Flange for 46957 | 68547.0 |
| 16407 | Large Crown (for Orange) for 46957 | 08162.0 | 78995 | Rubber Buffer for 46957 | 29538.8 | AE762 | Camera with Open Nozzle for 46957 | 68751.0 |
| 16408 | Small Crown (for Lemon) for 46957 | 08163.9 | 67038 | Grounded Wire Label for 46957 | 31140.5 | AE763 | Cover (Black) for 46957 | 68752.9 |
| 30044 | On/Off Label for 46957 | 10491.4 | 67039 | Nut M4 DIN 985 Stainless Steel for 46957 | 31800.0 | AE764 | Cup (Black) for 46957 | 69547.5 |
| 30045 | Bracer K22-LM(T-80I) for 46957 | 12469.9 | 30066 | Screw B.3,5x10 ZB PLAST.C/P for 46957 | 36366.9 | AE765 | Mold Screen 084735 (Black) for 46957 | 69548.3 |
| 30048 | Washer L.A4,3 for 46957 | 16798.3 | AE756 | CB. Earth 1.5mm2x350mm for 46957 | 48417.2 | AE766 | Closing the Fund for 46957 | 69840.7 |
| 79037 | Positive Terminal Lock for 46957 | 17581.1 | AE757 | Press CB.PG09 Black (CLCP09B) for 46957 | 60933.1 | AE767 | Black Base Ring for 46957 | 69851.2 |